

# Alfa Laval miniVISION Light Fitting

## Tank Accessories

### Introduction

The Alfa Laval miniVISION Light Fitting is a luminaire that fits the Alfa Laval Union Sight Glass based on DIN 11851, DIN 28120, and Alfa Laval LKS Sight Glass to illuminate and thereby provide free view of the process conditions inside tanks and vessels. It is suitable for all types of lighting situations where process hygiene is important.

### Application

The Alfa Laval miniVISION Light Fitting is designed to aid visual inspection of the process conditions inside tanks by lighting process conditions, products, and cleaning inside vessels across the dairy, food, beverage, personal care, biotechnology and pharmaceutical industries.

### Benefits

- Reliable operation
- One size for use on different sightglass diameter
- Quick and easy to install
- Low maintenance requirements
- Assists with early detection and response
- Helps prevent costly downtime
- Available with LED lighting
- Suitable for continuous operation

### Standard design

The Alfa Laval miniVISION Light Fitting consists of a housing and cover in AISI 304 stainless steel. Independent of internal vessel pressure, vacuum and temperature, it features a glass disc resistant to high temperatures, and gaskets resistant to corrosion and deformation.

The miniVISION is available in two sizes: type 53 and type 70. Type 53 provides sight and light in a single assembly combining the sight glass and the miniVISION Light Fitting. Type 70 only provides illumination.

The miniVISION is available in two versions: halogen and LED lighting.

The miniVISION Light Fitting can be ordered separately or together in packages with either the Alfa Laval LKS, or the Alfa Laval Sight Glass according to DIN 28120, or the Alfa Laval Union Sight Glass based on DIN 11851.



### Working principle

The Alfa Laval miniVISION Light Fitting illuminates process conditions or products in tanks or vessels, making visual inspection possible.

## TECHNICAL DATA

Cable gland:	Pg 9
Supply voltage:	AC or DC
Terminal voltage:	24 V

### Power

Type 53 (hallogen):	20 or 50 Watt
Type 70 (hallogen):	50 Watt
Type 53 (LED):	4 Watt

Max. current:	4.2 A
Bulb:	Halogen
Lamp sockets:	2-pin Socket G4 (20W) Socket GY 6.35 (50W)
Protection class:	IP 65

### Temperature

Ambient temperature:	-20 °C to +40 °C
Enclosure protection degree:	IP 65

## PHYSICAL DATA

### Materials

Housing and cover:	AISI 304
--------------------	----------

## Installation

The luminaire is normally mounted by means of its fixation elements, suitably slotted to take a fixing bolt M4. This bolt fits a drilled and tapped hole in the cover flange of Sight Glass acc. to DIN 28120 as well as in the grooved collar nut of a screwed sight glass (LKS or Union Sight Glass based on DIN 11851).

The very small dimensions of miniVISION type 53 enable sight and light in one assembly, still providing a high lighting power. It is possible to change the bulbs without having to demount the bolted-on luminaire.



**Note!** In case of repeated use of miniVISION type 53 within a short period, the temperature raise of the housing has to be observed.

## Dimensions (mm)

miniVISION Light Fitting type 53 with push button.

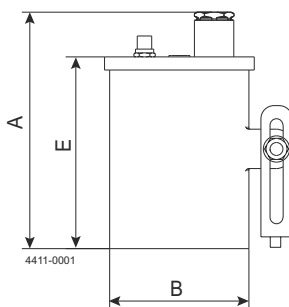

A	B	E
90	53	73

Sight glass LKS 78 and 120 with miniVISION type 53.

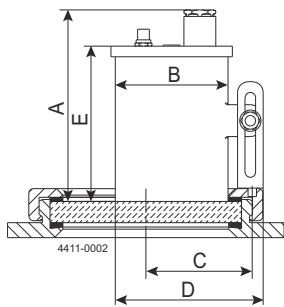

LKS size	A	B	C	D	E	Weight (kg)
78	90	53	48	72	73	0.30
120	90	53	69	72	73	0.30

Sight glass LKS 105 with miniVISION type 53.

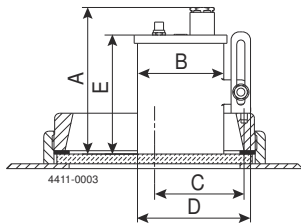

A	B	C	D	E
90	53	59	72	73

Sight Glass acc. to DIN 28120 with miniVISION type 53.

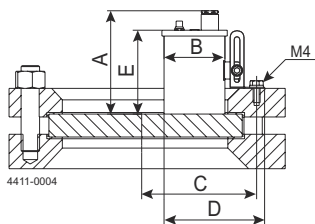

DN	A	B	C	D	E	Weight (kg)
100	90	53	87	90	73	0.30
125	90	53	100	90	73	0.30
150	90	53	112	90	73	0.30

Union Sight Glass based on DIN 11851 with miniVISION type 53.

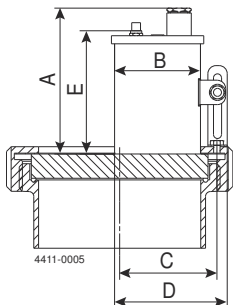

DN	A	B	C	D	E	Weight (kg)
65	90	53	39	72	73	0.30
100	90	53	57	72	73	0.30
125	90	53	69	72	73	0.30

miniVISION Light Fitting type 70.

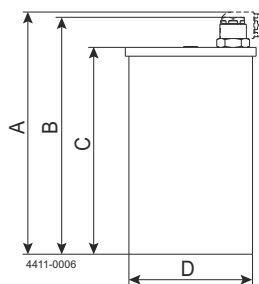

A	B	C	D
141	134	117	70

Sight glass LKS 78 with miniVISION type 70.

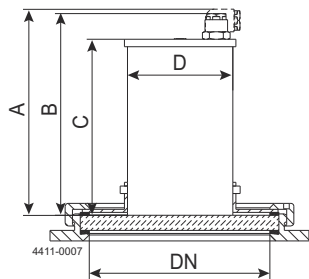

DN	A	B	C	D
78	141	134	117	70

Sight glass LKS 105 with miniVISION type 70.

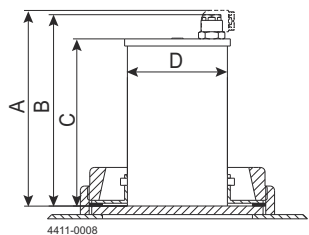

A	B	C	D
141	134	117	70

Union Sight Glass based on DIN 11851 with miniVISION type 70.

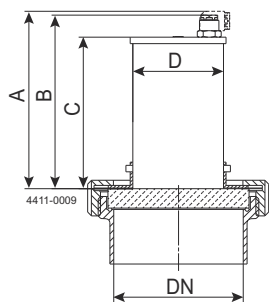

DN	A	B	C	D
65	141	134	117	70



**Note!** For size DN 65 (only).

## Ordering

When ordering, please state the following:

- Type and size of sight glass on which the luminaire has to be mounted
- Power
- Sight Glass type to be delivered with the light fitting, if needed

This document and its contents are subject to copyrights and other intellectual property rights owned by Alfa Laval Corporate AB. No part of this document may be copied, re-produced or transmitted in any form or by any means, or for any purpose, without Alfa Laval Corporate AB's prior express written permission. Information and services provided in this document are made as a benefit and service to the user, and no representations or warranties are made about the accuracy or suitability of this information and these services for any purpose. All rights are reserved.

200006898-1-EN-GB

© Alfa Laval Corporate AB

---

**How to contact Alfa Laval**

Up-to-date Alfa Laval contact details for all countries are always available on our website at [www.alfalaval.com](http://www.alfalaval.com)